

# INSTALLATION MANUAL

65738A

ecolight



ADJUSTABLE



200mm

80mm

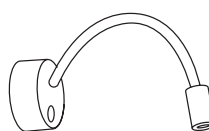

one  
LIGHT

100-240V | 3W | IP20 | Aluminium

Complete with driver.

85  
CRI

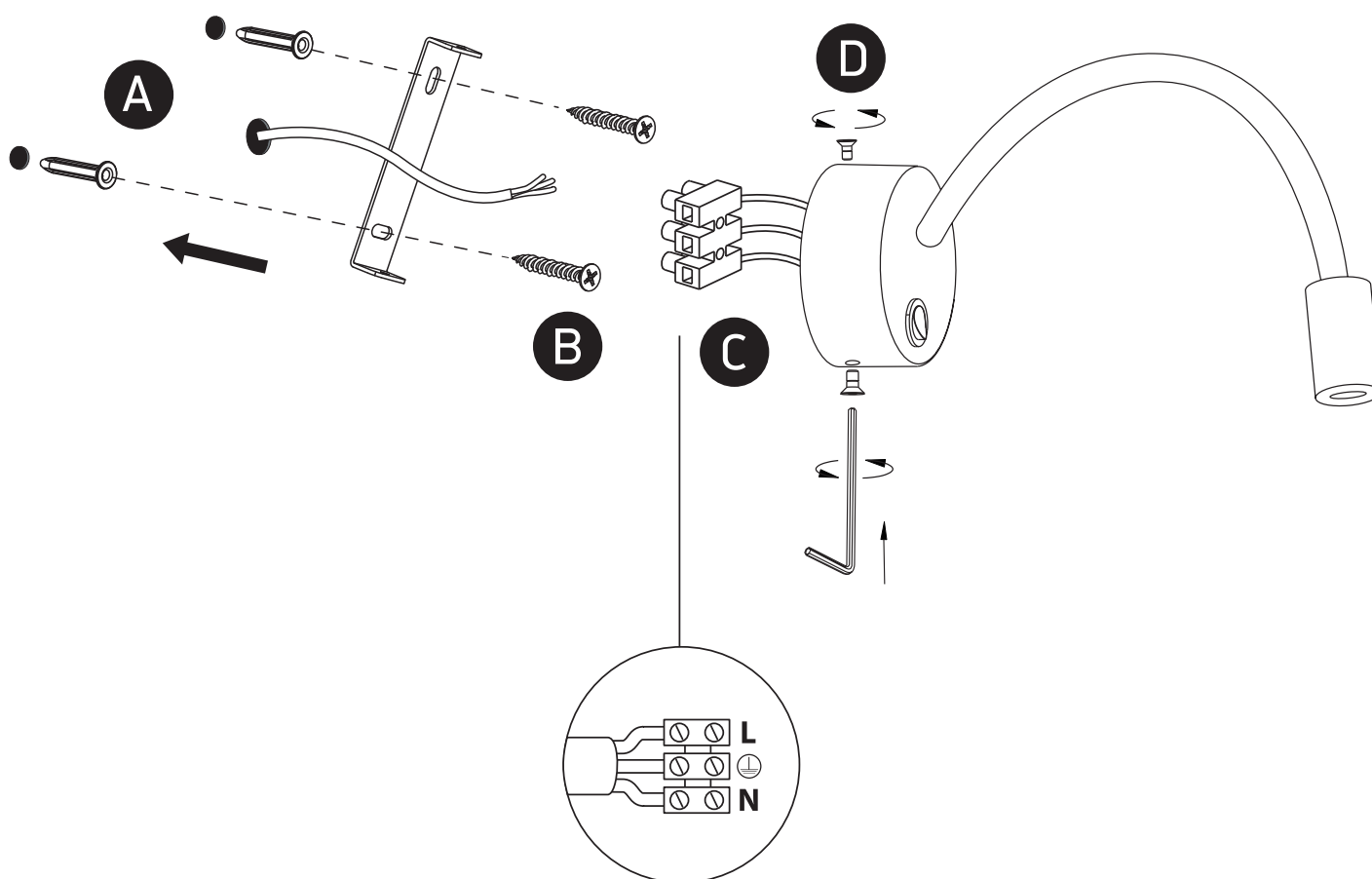

## Warnings:

1. Make sure that the product is installed properly before connecting to electricity.
2. Do not cover the fitting.
3. Maintenance and installation should only be carried out by a professional electrician.