

# INSTALLATION MANUAL

67218

LED  
BUILT IN



80  
CRI

CE ENEC UK CA

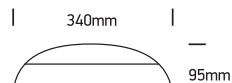

230V | SMD 2835 | 15W | IP65 | CCT Adjustable | Plastic

Complete with 180mA driver.

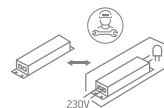

one  
LIGHT

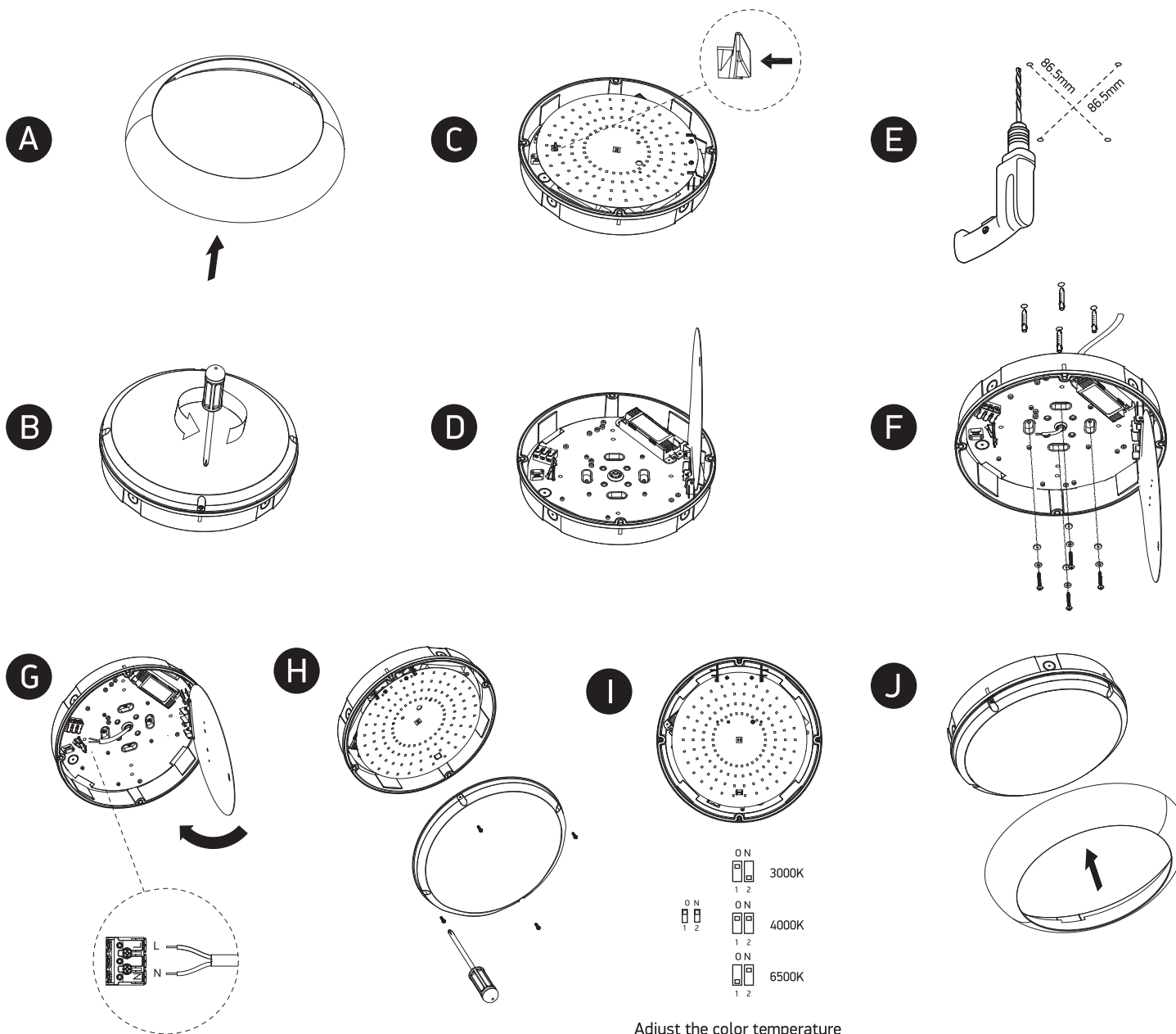

## Warnings:

1. Fix the base on the ceiling.
2. Make sure that the product is installed properly before connecting to electricity.
3. Connect the AC power cable to the driver's cable as shown in the above diagram.
4. Do not cover the fitting.
5. Maintenance and installation should only be carried out by a professional electrician.