

# INSTALLATION MANUAL

68064

**ecolight**



80  
CRI

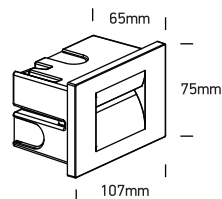

100-240V | 3,6W | IP65 | Die cast

Complete with driver.  
Supplied with box for  
concrete installation.

97x  
62mm  
Concrete  
installation

95x  
60mm  
Gypsum  
installation

65mm

**one**  
LIGHT

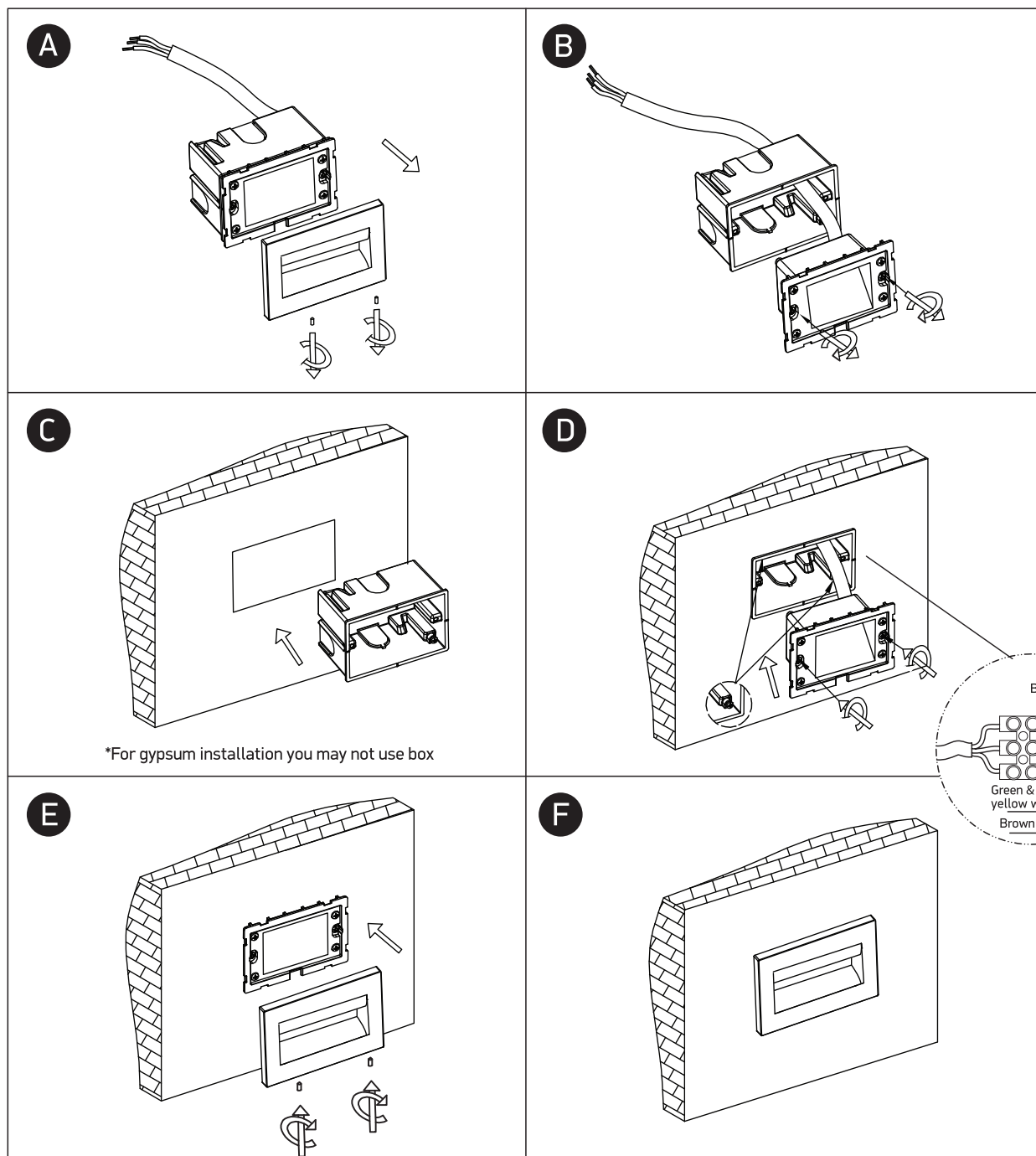

## Warnings:

1. Make sure that the product is installed properly before connecting to electricity.
2. Do not cover the fitting.
3. Maintenance and installation should only be carried out by a professional electrician.