

# PAGODA

by David Villalba

Lámpara-Pendant lamp

CRI≥90 UGR<16

**7784 Blanco-White**  
LED 12,5W 3000K 950lm

**7785 Blanco-White**  
LED 12,5W 4000K 1050lm

**7786 Negro-Black**  
LED 12,5W 3000K 950lm

**7787 Negro-Black**  
LED 12,5W 4000K 1050lm



7788  
pág. 214

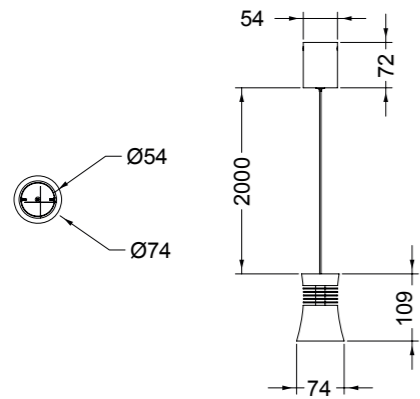

TIR LENS



UGR<16



Aluminio-Aluminium 220-240V - 50/60Hz CRI: > 90

PAGODA

Lámpara-Pendant lamp

**7790 Blanco-White**  
1x GU10 (no incl)

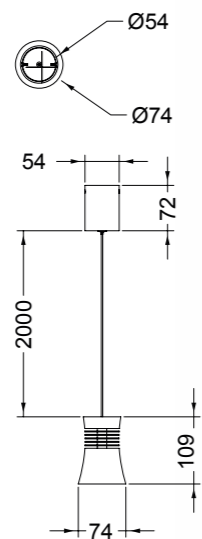

**7791 Negro-Black**  
1x GU10 (no incl)



7788  
pág. 214



NOT INCLUDED



garantía mantraco 2 años WARRANTY GARANTIA



IP20

Aluminio-Aluminium 100-240V ~ 50/60Hz GU10 máx. 12W LED (no incl)





# PAGODA

by David Villalba

7788 Blanco-White

1x GU10

7789 Negro-Black

1x GU10

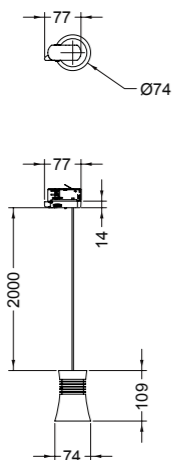

7787  
pág. 164



Metal-Metal 100-240V ~ 50/60Hz máx. 12W LED



# PAGODA

CRI≥90 UGR<16

**7780 Blanco-White**  
LED 12,5W 3000K 950lm



**7781 Blanco-White**  
LED 12,5W 4000K 1050lm

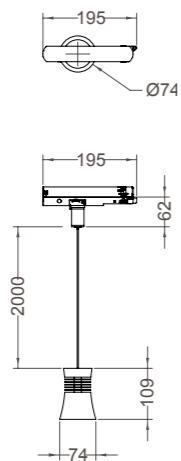

**7782 Negro-Black**  
LED 12,5W 3000K 950lm



**7783 Negro-Black**  
LED 12,5W 4000K 1050lm



TIR LENS

UGR<16



Aluminio-Aluminium 220-240V~ 50/60Hz CRI: > 90