

MATCH ceiling recessed

INSTALLATION INSTRUCTIONS | OCTOBER 2024

installation with wire springs 1.0 / 2.0

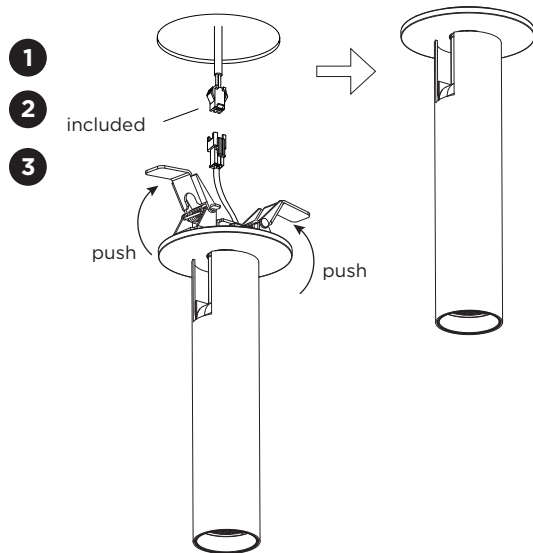

installation with blade springs

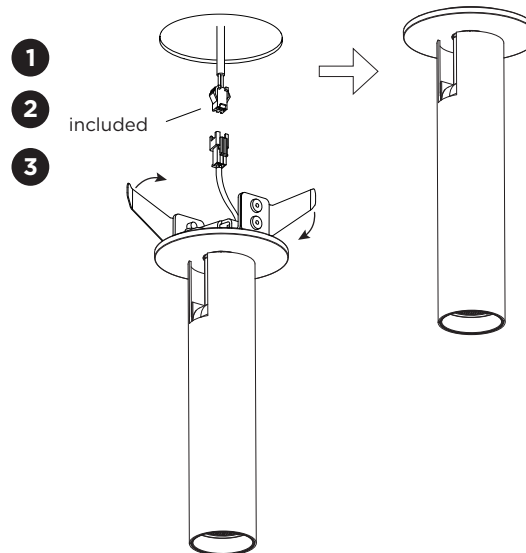

DIMENSIONS

1.0 LED
with wire springs

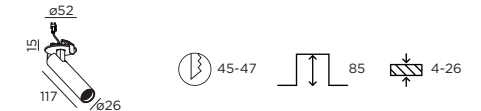

1.0 LED
with blade springs

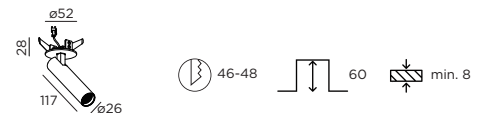

2.0 LED
with wire springs

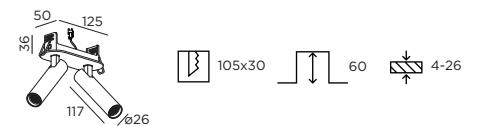

MOUNTING INSTRUCTION

- 1 Make a hole in the ceiling according to the prescribed dimensions.
- 2 **POWER CONNECTION**
Always use a driver according to the specifications of the LED module.

Single connection

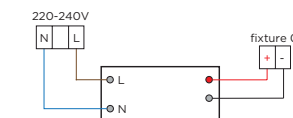

Multiple connection

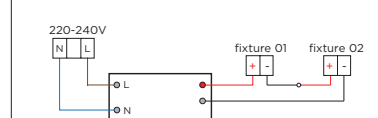

- 3 For wire springs: push the springs upward and insert the fixture in the ceiling hole.

For blade springs: push the blades towards the fixture and insert the fixture in the ceiling hole.

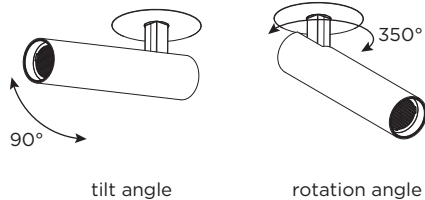

Only to be installed outside arms reach.



Driver must be powered off before connecting the cables.

Before connecting the luminaire/LED module to the driver please make sure the driver is not powered but disconnected from the mains. The driver can only be powered when the luminaire/LED module is already connected. Disregarding this instruction might damage or even destroy the luminaire/LED module.

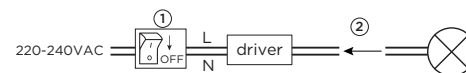

WEVER & DUCRÉ
LIGHTING

WEVER & DUCRÉ BV

Spinnerijstraat 99/21, 8500 Kortrijk, Belgium
weverducre.com

MATCH ceiling recessed

INSTALLATION INSTRUCTIONS | OCTOBER 2024

dismounting for 1.0 / 2.0

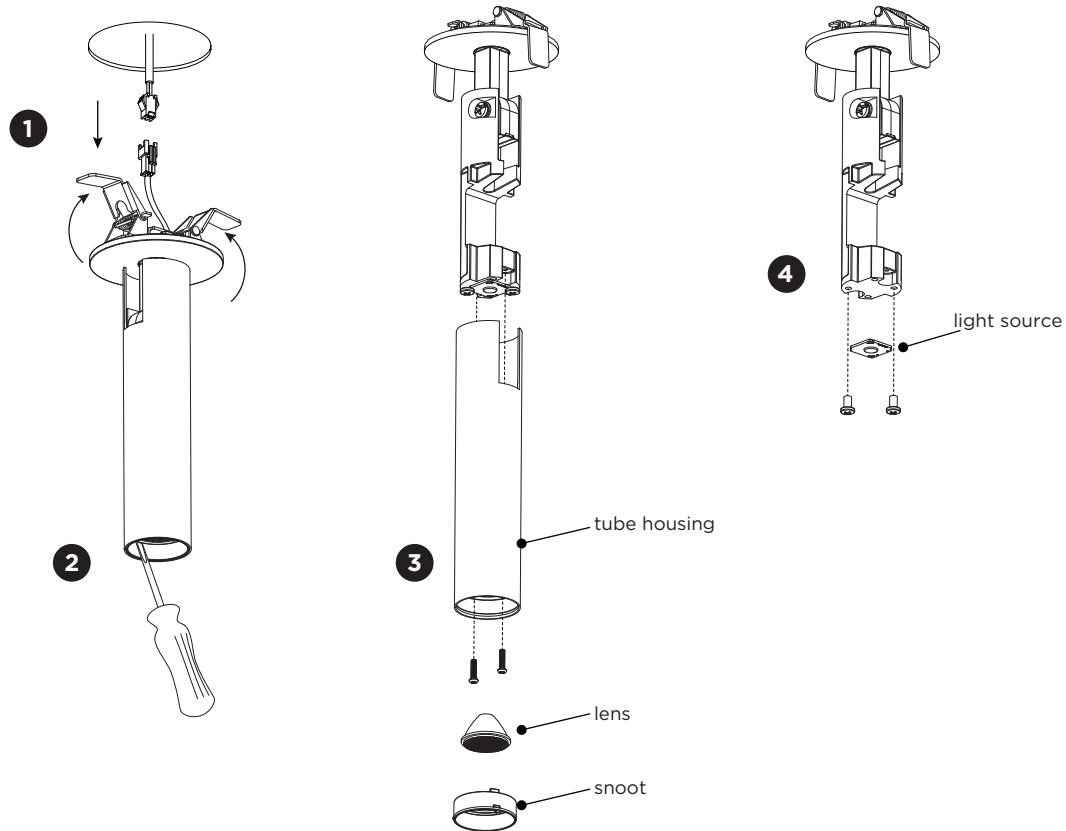

DISMOUNTING AND RECYCLING INSTRUCTIONS

Light source

- 1** Pull the fixture out from the ceiling and disconnect the connectors.
- 2** Pull out the snoot(s) using any available tools and remove the lens(es).
- 3** Unscrew the screws and remove the tube housing(s).
- 4** Disconnect the wires and unscrew the light source(s) to remove it/them.

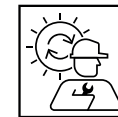

The light source is replaceable by Wever & Ducreé or by a professional with explicit authorisation. For more information please contact your local Wever & Ducreé customer service point.



This luminaire contains a light source with the energy class E.



WEVER & DUCRÉ
LIGHTING

WEVER & DUCRÉ BV

Spinnerijstraat 99/21, 8500 Kortrijk, Belgium
weverducre.com