

TAIO recessed

INSTALLATION INSTRUCTIONS | OCTOBER 2024

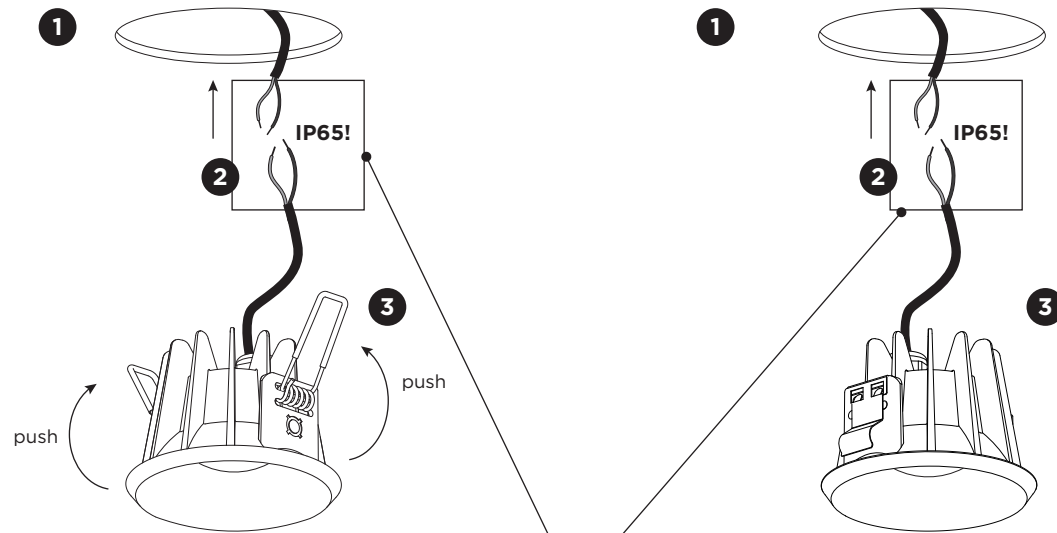

Included:

waterproof connectors:



Optional:

IP68 connection box:

order ref. 73240705 = 2 WAYS 2x0,75Ø4,8-6mm

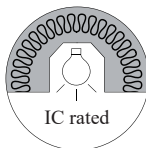

Driver must be powered off before connecting the cables.

Before connecting the luminaire/LED module to the driver please make sure the driver is not powered but disconnected from the mains. The driver can only be powered when the luminaire/LED module is already connected. Disregarding this instruction might damage or even destroy the luminaire/LED module.

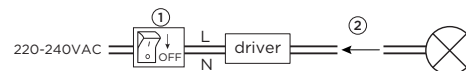

DIMENSIONS

1.0 LED with wire springs

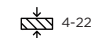
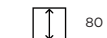

1.0 LED with blade springs

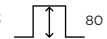

MOUNTING INSTRUCTION

1 Make a hole in the ceiling according to the prescribed dimensions.

2 POWER CONNECTION

Always use a driver according to the specifications of the LED module.

Make sure to use a waterproof connection with the same IP rating as the luminaire.

Single connection



Multiple connection

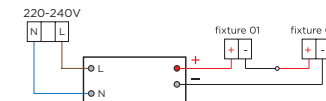

3 For wire springs: push the springs up and insert the fixture in the ceiling hole.

For blade springs: insert the fixture in the ceiling hole.

WEVER & DUCRÉ BV

Spinnerijstraat 99/21, 8500 Kortrijk, Belgium
weverducre.com

PB19-010-737-00_v2

TAIO recessed

INSTALLATION INSTRUCTIONS | OCTOBER 2024

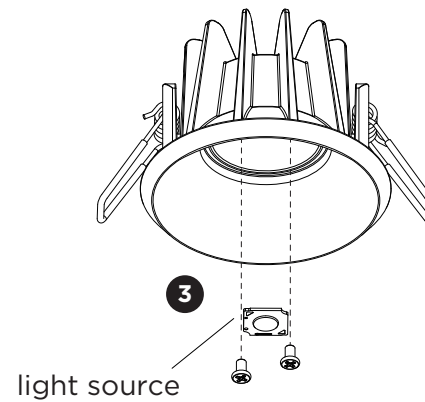
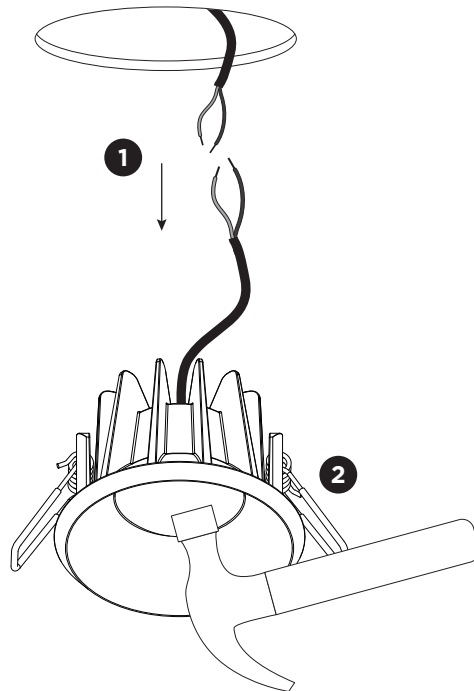

DISMOUNTING AND RECYCLING INSTRUCTIONS

Light source & driver

- 1 Remove the fixture from the ceiling hole and loosen the wires.
- 2 Break the lens.
- 3 Unscrew the light source to remove it.

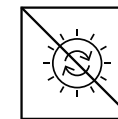

The light source is not replaceable.



This luminaire contains a light source with the energy class D.