

## PRODUCT DESCRIPTION

- Minimum width and height
- Small bending radius

### FINISH :

Silver anodized Black anodized 

\*Custom colors available upon request



Fill empty fields

Product nr.

Fixture type

Company

Job name

Date

## TECHNICAL SPECIFICATION

### Application

- furniture and decorative lighting.

### Mounting

- to the surface, suspended or recessed, using dedicated accessories, with double-sided adhesive tape or mounting adhesive,
- the cover is cut to the length of the profile,
- easy assembly and disassembly by snapping in and out.

### Additional information

- possibility of making a linear fixture with IP67 protection, which means the fixture is dustproof and waterproof
- frosted covers (diffusers) and aluminum-colored plastic end caps are available for this extrusion
- fast and reliable installation of sealed LED strips "5-KLIK" (LED strip in a special silicone sleeve ensuring increased tightness)
- ideal for use in bathrooms and other rooms with high humidity
- space for LED strip: 7.2 mm

### Profile bending

| Minimum internal radius | Minimum external radius |
|-------------------------|-------------------------|
| 150 mm                  | 150 mm                  |

- minimum radius - bending radius which when exceeded causes destruction (deformation, bending or lack of compatibility with other accessories, e.g. covers, end caps, etc.) of the profile
- internal radius - refers to the profile bent so that the cover is facing the inside of the arch

- external radius - refers to the profile bent so that the cover is facing the outside of the arch
- irregular curves are possible after consultation and individual quotation
- when bending anodized profiles, one should be aware of cracking of the anode coating (which may be more or less visible depending on the radius)

### AVAILABLE LENGTHS

| Ref. nr.     | surface finish  | available lengths |
|--------------|-----------------|-------------------|
| B8288ANODA_1 | Silver anodized | 1000 mm           |
| B8288ANODA_2 | Silver anodized | 2000 mm           |
| B8288ANODA_3 | Silver anodized | 3000 mm           |
| B8288K7_1    | Black anodized  | 1000 mm           |
| B8288K7_2    | Black anodized  | 2000 mm           |
| B8288K7_3    | Black anodized  | 3000 mm           |

### TECHNICAL DRAWING

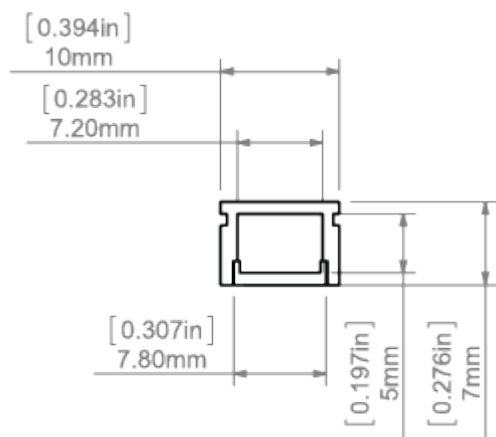

## RELATED PRODUCTS

### COVERS

#### FROSTED COVERS

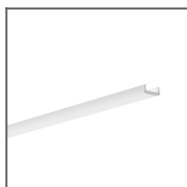

PIKO frosted Cover  
Ref: 17034

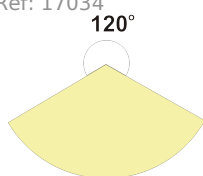

### END CAPS

#### REGULAR END CAPS

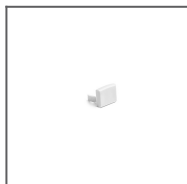

PIKO grey End cap  
Ref: 24202



PIKO-OTW grey End cap  
Ref: 24299

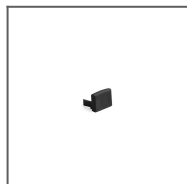

PIKO black End cap  
Ref: 24379

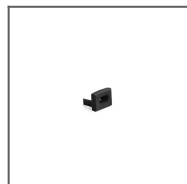

PIKO-OTW black End cap  
Ref: 24399

### ACCESSORIES

#### FASTENERS & MOUNTING ACCESSORIES



K-10 Mounting bracket  
Ref: 24340



K-10-PP Fastener silver  
Ref: 42670



K-10-WL Fastener silver  
Ref: 42672



K-10-WP Fastener silver  
Ref: 42671

### SEALING COMPONENTS



6 x 1.2 Gland  
Ref: 00802

## MARKETING MATERIALS



Display  
P230-90107M  
Ref: 90107M



Presentation set 6  
Ref: 90125

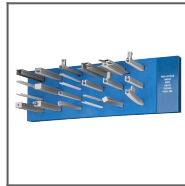

Foam 70341  
Ref: 70341



Display  
P230-90172M  
Ref: 90172M

## LED TAPES



LED strip 5K-WP-  
K-1091-24V  
Ref: 5K-WP-  
K-1091-24V

## WHITE

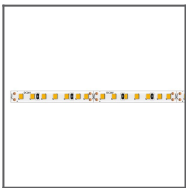

LED strip  
K-1091-24V  
Ref: K-1091-24V

## RGB / RGB-W

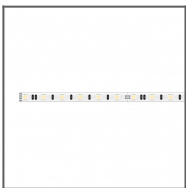

LED strip K-1560-  
RGB-24V  
Ref: K-1560-  
RGB-24V